

Model	Applicable To	File Under	Bulletin No.
1997 PRELUDE	ALL	BODY	97-039
			Issue Date MAY 1997

Service Manual Update: Mirror Replacement

The 1997 Prelude Service Manual incorrectly describes the *Mirror Replacement* procedure. Make a note on the correct service manual page in the Body section to refer to this service bulletin.

MIRROR REPLACEMENT

1. Pivot the mirror to access the center ball/socket from the top.

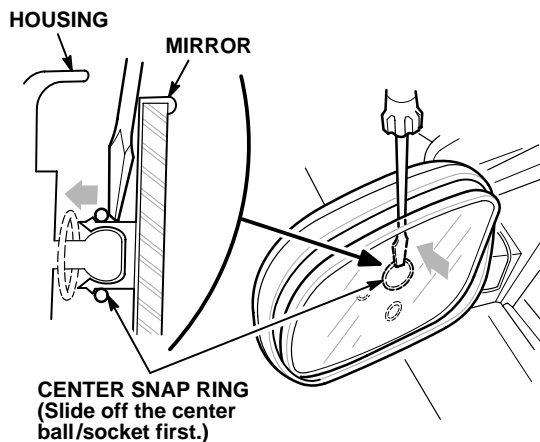

2. Slide the snap ring off the center mirror socket, and pry lightly with a flat-tip screwdriver on the mirror to separate the ball from the socket.
3. Repeat the procedure for the bottom worm-drive ball/socket, then the left ball/socket. Make sure you follow this order to prevent damaging the actuator.

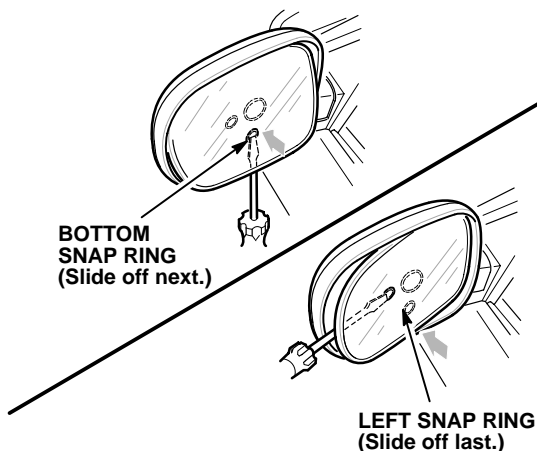

4. Remove the mirror, and retain the snap rings.

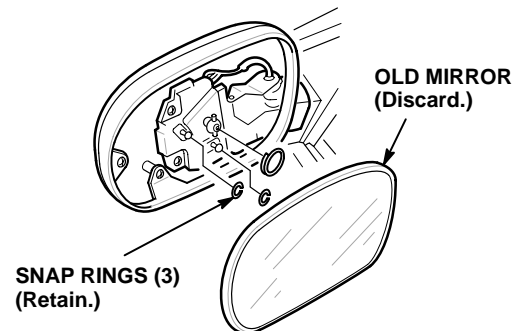

5. Install the snap rings onto the new mirror.

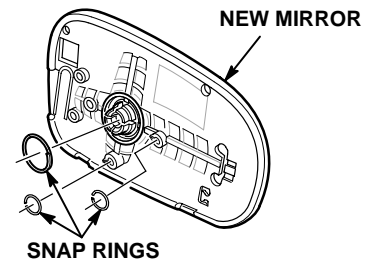

CAUTION

Wear leather gloves to protect your hands from broken glass in case the mirror breaks during installation.

6. Press on the center of the mirror to reconnect each ball/socket. To prevent the glass from breaking, do not apply excessive pressure on the sides of the mirror.

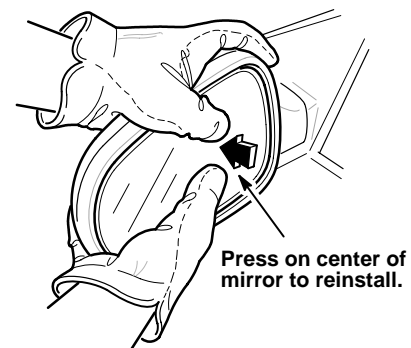

WARRANTY CLAIM INFORMATION

None; this is for information only.