

## Rear Wheel Bearing Noise

### SYMPTOM

A whining noise from the rear wheels. At first, only at highway speeds, but, over time, becoming noticeable at low speeds.

### PROBABLE CAUSE

The rear bearing hub caps were not manufactured correctly, allowing water to leak into the hub bearing assemblies, and contaminating the bearings.

### VEHICLES AFFECTED

1992 – 96 Prelude – ALL

1990 – 96 Accord – ALL

1997 Accord – 2-door thru VIN 1HGCD7 . . . VA009547  
2 doors

KC	thru VIN	1HGCD7238VA800663
KE	thru VIN	1HGCD72400A300421
KG	thru VIN	1HGCD71400A300361
KK	thru VIN	1HGCD7266VA010938
KY	thru VIN	1HGCD7258VA009597

4 doors

KB	thru VIN	1HGCD5641VA700301
KC	thru VIN	1HGCD5609VA805609
KH	thru VIN	1HGCD5654VA130190
KK	thru VIN	1HGCD5539VA080077
KM	thru VIN	1HGCD5660VA670001
KV	thru VIN	1HGCD5613VA097695

4 doors V6

KH	thru VIN	1HGCE6656VA009065
----	----------	-------------------

5 doors

KE	thru VIN	1HGCE27300A300721
KG	thru VIN	1HGCE27800A300841
KK	thru VIN	1HGCE1830VA300843
KZ	thru VIN	1HGCE17500A300901

1995 – 96 Odyssey – ALL

1997 Odyssey – Thru VIN JHMRA1 . . . VC003933

### CORRECTIVE ACTION

Replace the failed hub bearing assembly, then install new rear bearing hub caps.

## PARTS INFORMATION

Rear Bearing Hub Cap (2 required):  
P/N 42326-SG0-000

Spindle Nut:

All except Accord V6 and Wagon  
P/N 90305-692-010

Accord V6 and Wagon  
P/N 90305-SD4-003

Rear Hub Bearing Assembly:

*Prelude*

Si/Si 4WS/SE/VTEC  
P/N 42200-SS0-981

S model

P/N 42200-SM4-A01

*1990 – 93 Accord*

4-door and 2-door w/ABS  
P/N 42200-SM4-J51

4-door and 2-door w/o ABS  
P/N 42200-SV1-008

Wagon w/ ABS P/N 42200-SM5-A51

Wagon w/o ABS

P/N 42200-SV4-N02

*1995– 97 Accord V6*

P/N 42200-SV2-N51

*1994 – 97 Accord*

4-door and 2-door, EX and LX w/ABS

P/N 42200-SV1-J51

4-door and 2-door, DX and LX w/o ABS

P/N 42200-SV1-008

*1994 – 95 Accord Wagon*

EX and LX w/ABS

P/N 42200-SV4-N51

LX w/o ABS

P/N 42200-SV4-N02, H/C 4574877

*1996 – 97 Accord Wagon*

EX and LX w/ABS

P/N 42200-SV2-N51

LX w/o ABS

P/N 42200-SV2-N01

Odyssey: P/N 42200-SX0-951

## WARRANTY CLAIM INFORMATION

**In warranty:** The normal warranty applies.

## REPAIR PROCEDURE

1. Determine which rear hub bearing assembly has failed, and replace it with the correct one listed under PARTS INFORMATION. Refer to section 18 of the appropriate service manual for instructions.

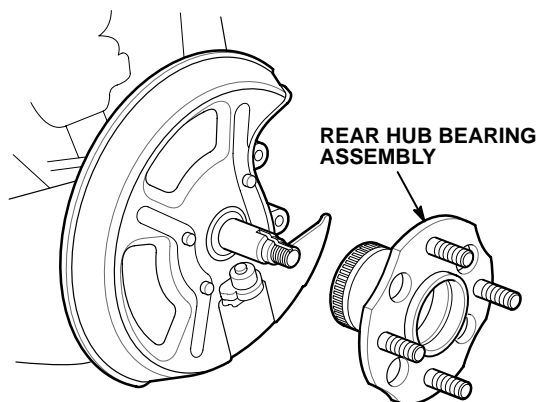

2. Install a new spindle nut, and tighten it to the correct torque specification. Use a drift to stake the spindle nut shoulder against the spindle.

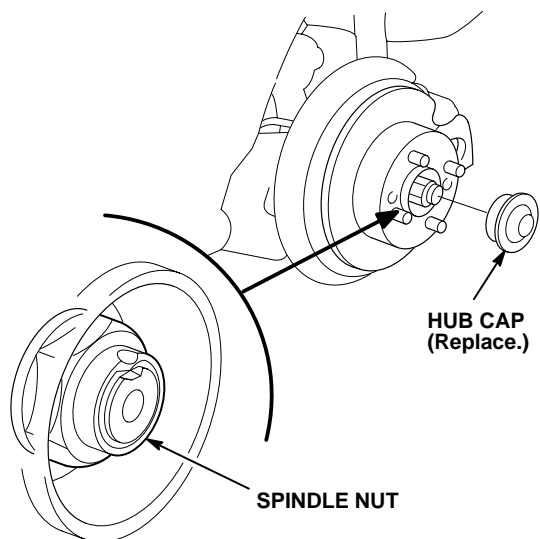

3. Install new bearing hub caps on both sides.  
**NOTE:** Both bearing caps must be replaced; otherwise the bearings may fail again in the future.