



Safety Recall: Rear Door Latch Assembly

BACKGROUND

Some sliding doors may not latch properly. An improperly latched door could open unexpectedly while the vehicle is in motion.

CUSTOMER NOTIFICATION

All the owners of affected vehicles must be notified of this recall by the distributor. An example of the customer notification is at the end of this service bulletin.

VEHICLES AFFECTED

2000 Odyssey Ex:

KX: VIN 2HKRL1...YH900339
From VIN 2HKRL1...YH900422 thru
2HKRL1...YH900541

KY: From VIN 2HKRL1...YH700190 thru
2HKRL1...YH700249

KA (NATO): VIN 2HKRL1...YH540845
VIN 2HKRL1...YH541174
VIN 2HKRL1...YH541433

PARTS INFORMATION

Right Door Latch Assembly: P/N 72610-S0X-A53

Left Door Latch Assembly: P/N 72650-S0X-A53

WARRANTY CLAIM INFORMATION

In warranty: The normal warranty applies.

Operation Number: 821115

Flat Rate Time: 1.2 hours

Failed Part: P/N 72650-S0X-A52

Defect Code: 331

CORRECTIVE ACTION

Replace both of the door latch assemblies.

REPAIR PROCEDURE

1. Use a trim pad remover to unclip the front and rear upper trim pieces. Unhook the trim pieces at the bottom and remove them. Do not bend or crease the trim pieces during removal.

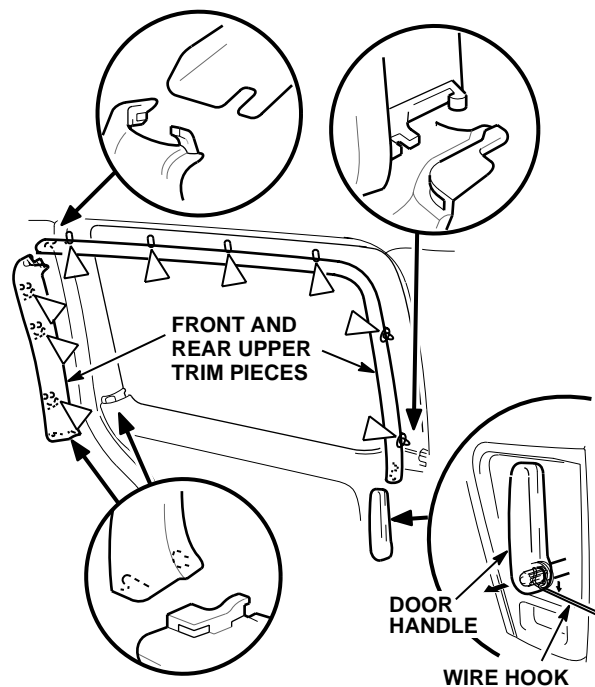

2. Use a wire hook to remove the clip from the inside door handle. Remove the door handle.

3. Pry out the cap behind the door handle, then remove the screw. Use the trim pad remover to unclip and remove the inside door panel. Do not bend or crease the door panel during removal.

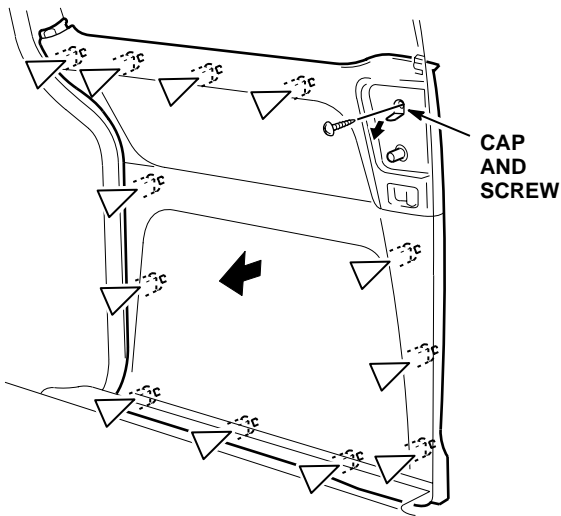

4. Remove the lock knob.

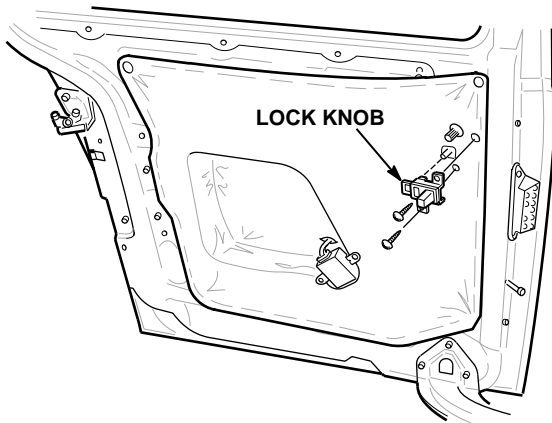

5. *Left door only:* Disconnect the 8P connector from the door lock control unit. Remove the door lock control unit.

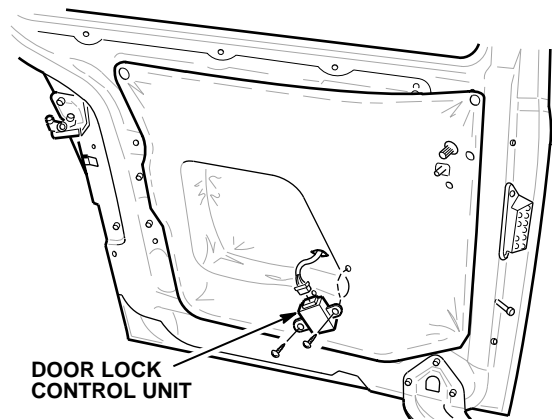

6. Remove the plastic inner door cover.

7. Remove the six mounting bolts for the latch assembly. Disconnect the 6P latch connector. Disconnect the door latch cable, the auto-close cable, and the lower roller lever cable. Remove the latch assembly from the door.

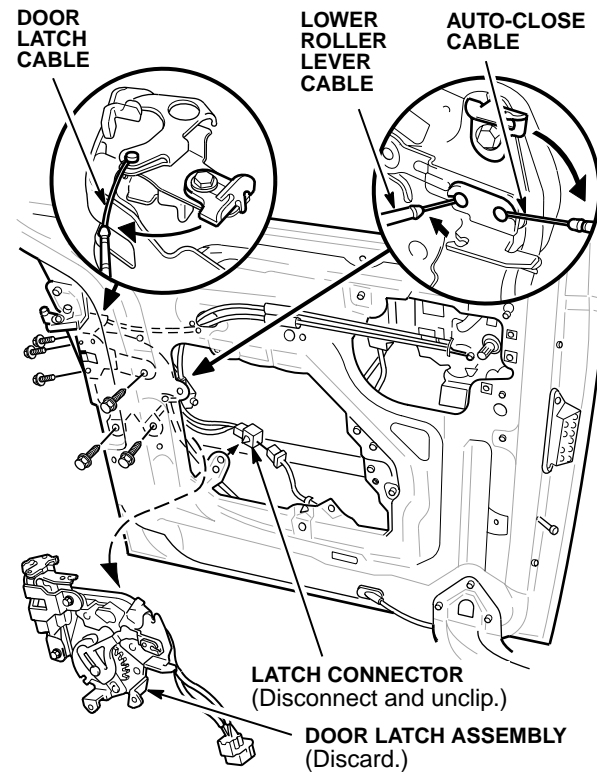

8. Disconnect the door latch cable and the auto-close cable from the door latch remote controller assembly. Discard the cables.

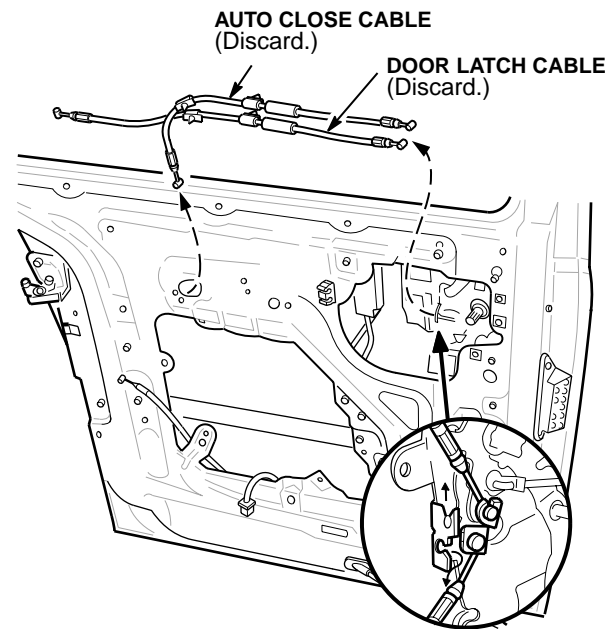

9. Connect the lower roller lever cable to the new door latch assembly.

10. Install the new door latch assembly in the door.

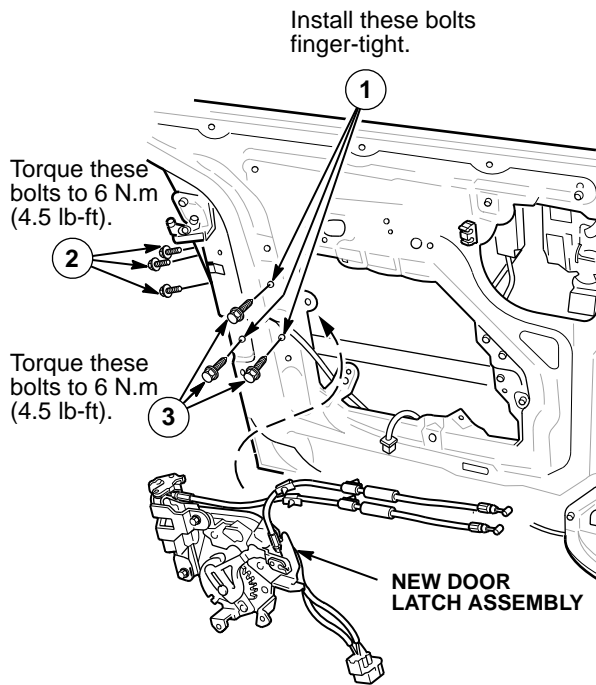

11. Route the cables.

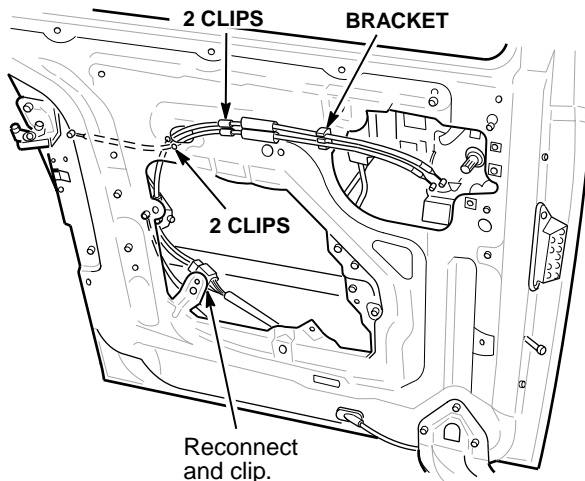

12. Connect the door latch cable and the auto-close cable to the door latch remote controller. Make sure the cables are routed and installed properly.
13. Reconnect the 6P latch connector. Clip the connector to the door.
14. Reinstall the plastic inner door cover and the lock knob.
15. *Left door only:* Reinstall the door lock control unit. Reconnect the 8P connector.
16. Use the switch on the instrument panel to close the door. This resynchronizes the control unit. Then test the door operation with the switch, the door handles, and the remote transmitter. Make sure it opens and latches properly.
17. Reinstall the inside door panel.

18. Reinstall the inside door handle.
19. Reinstall the front and rear upper trim pieces.
20. Repeat this procedure on the other door.
21. Center-punch a completion mark above the eleventh character (H) of the engine compartment VIN.

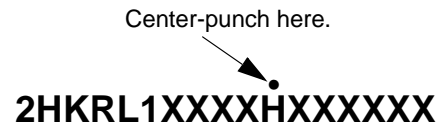

Example of Customer Letter

July 2000

Safety Recall: Odyssey Rear Door Latch

Dear Odyssey Owner:

This notice is sent to advise you of a safety recall affecting your vehicle.

What is the reason for this notice?

Honda Motor Co., Ltd. has determined that a defect relating to motor vehicle safety may exist in the sliding door latches of some 2000 Odyssey vehicles. Some latches were improperly manufactured and, as a result, the latching mechanism may bind and prevent the door from latching properly. An improperly latched door could open unexpectedly while the vehicle is in motion. Under certain circumstances, a door could open completely but, in most cases, it will open only partially. An unrestrained rear seat passenger could fall out of an open door of a moving vehicle and be seriously injured or killed.

Although the unlatched condition may not be obvious to the person closing the door, the driver would immediately be made aware of the unlatched condition by the illumination of the instrument panel's door and brake lamp monitor (illustrated below, including the owner's manual text). In addition, your vehicle has an audible signal that warns the driver if a sliding door is not properly latched.

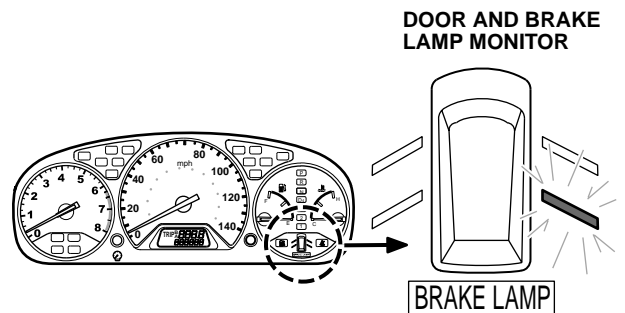

The appropriate light comes on in this display if the tailgate or any other door is not closed tightly.

What should you do?

Call any authorized Honda automobile distributor/dealer and make an appointment to have your vehicle repaired. The distributor/dealer will replace the door latch assemblies in both doors. *This repair will be done free of charge.* Although this repair takes about an hour, please plan to leave your vehicle for half a day to allow them flexibility in scheduling.

What to do if you feel this notice is in error.

This notice was mailed to you according to the latest information we have. If you no longer own this vehicle, or some information in this notice is incorrect, please notify your local distributor/dealer.

(Enter Distributor name, address, and telephone number)

If you have questions.

If you have any questions about this notice, or need assistance with contacting a Honda dealer, please contact ***(enter Distributor name and telephone number)***.

We apologize for any inconvenience this may cause you.

Sincerely,

(Enter Distributor name)