



Product Update: CR-V Throttle Cable

BACKGROUND

Contamination on the throttle drum can cause the throttle cable to move with the cruise control cable. If this happens when you cancel the cruise control function, the throttle cable can jump its track on the throttle drum, resulting in no throttle response.

VEHICLES AFFECTED

2002 CR-V with Cruise Control:

KX - From VIN JHLRD7...2C600001
thru JHLRD7...2C602705

2003 CR-V with Cruise Control:

KX - From VIN JHLRD7...3C600001
thru JHLRD7...3C607200

KM - From VIN JHLRD7...3C206022
thru JHLRD7...3C208293

Not all vehicles within the VIN range are affected by this product update. Before beginning work on a vehicle, verify its eligibility by checking your vehicle campaign responsibility report.

CUSTOMER NOTIFICATION

All owners of affected vehicles should be sent a notification of this product update. An example of the customer notification is enclosed with this service bulletin.

If any affected vehicles are in your new or used vehicle inventory, repair them as described in this service bulletin.

CORRECTIVE ACTION

Install a cap on the throttle drum.

PARTS INFORMATION

Throttle Drum Cap: P/N 16403-PPA-003

WARRANTY CLAIM INFORMATION

Operation Number: 222105

Flat Rate Time: 0.2 hour

Failed Part: P/N 17910-S9A-A03

Defect Code: 5CC

Contention Code: P03

REPAIR PROCEDURE

1. Remove the throttle linkage cover from the throttle body.

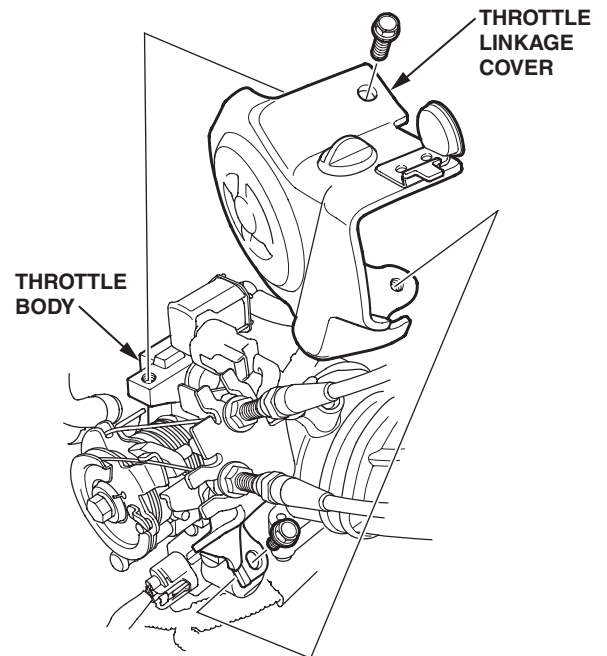

2. Install the throttle drum cap on the throttle drum by pressing its lower half onto the drum and then snapping its upper tab into place.

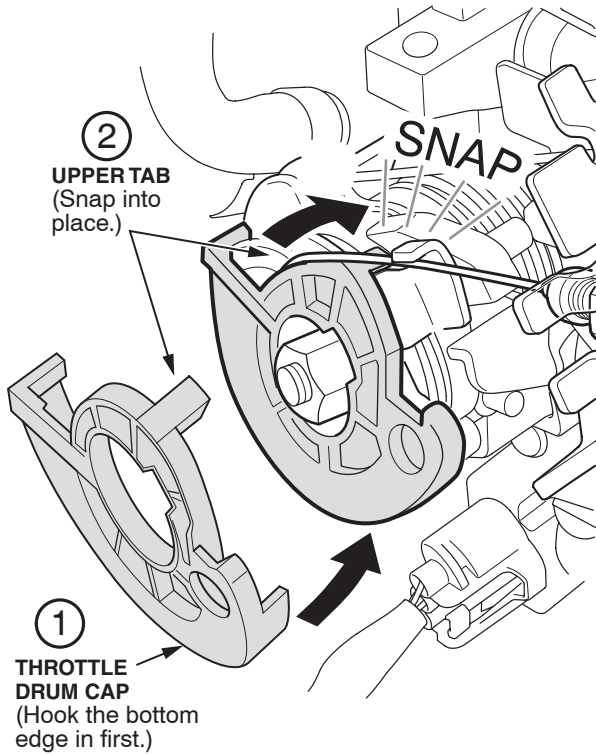

3. Rotate the throttle drum, and make sure the cap is completely seated.
4. If there is a gap between the cap and the throttle drum, remove and discard the cap, then repeat steps 2 and 3 with a new cap.
5. Install the throttle linkage cover, and torque the bolts to 12 N·m (8.7 lb-ft).
6. Center-punch a completion mark above the fifth character of the engine compartment VIN.

Center-punch here.

JHLRDXXXXXXXXXXX

Example of Customer Notification Letter

September 2003

Product Update: CR-V Throttle Cable

Dear CR-V Owner:

This notice has been sent to inform you of a potential problem with your vehicle and what you should do to resolve it.

What is the problem?

Contamination by dirt and other debris can cause the throttle cable to move when the cruise control cable moves. If this happens, it can cause the throttle cable to jump its track when you cancel the cruise control. The engine will then not respond to the accelerator pedal.

What should you do?

Call any authorized Honda distributor, and make an appointment to have your vehicle updated. The distributor will install a cap on the throttle cable drum to keep the throttle cable on its track. This work will be done *free of charge*. Please plan to leave your vehicle at the distributor for half a day to allow them flexibility in scheduling.

What to do if you feel this notice is in error.

Our records show that you are the current owner or lessee of a 2002–03 CR-V involved in this product update. If this is not the case, or the name/address information is incorrect, please inform your distributor. This will help us update our records.

If you have questions.

If you have questions about this notice or need assistance, please contact *(insert your distributor name and telephone number)*.

We apologize for any inconvenience this update may cause you.

Sincerely,

Insert your distributor name.