



RECALL: Automatic Transmission Shift Linkage

(Supersedes 94-010, dated April 11, 1994)

BACKGROUND

In models equipped with automatic transmissions, a retaining clip connects the transmission shift cable to the shift lever actuating rod. Some retaining clips have insufficient retention pressure and may come off after repeated shift lever operation. If this happens, the position of the shift lever may not match the actual transmission gear position. This could result in the vehicle moving unexpectedly, which could lead to an accident, or the car might not move at all.

VEHICLES AFFECTED

With Automatic Transmission:

- 1992 – Mid to late production
- 1993 Civic – ALL
- 1994 Civic – Early production

PARTS INFORMATION

Adjuster Pin: P/N 54363-689-981

WARRANTY CLAIM INFORMATION

In warranty: The normal warranty applies.

Operation Number: 21420

Flat Rate Time: 0.3 hour

Failed Part: P/N 54363-SP0-A81

Defect Code: 272

For optional front console with CD player or equalizer:

Operation Number: 21420A

Flat Rate Time: Add 0.3 hour

CORRECTIVE ACTION

Replace the transmission shift linkage adjuster pin with the new part listed under PARTS INFORMATION.

1. Remove the center console. Refer to the transmission section of the appropriate shop manual for the proper procedure.
2. Move the shift lever to Neutral.

3. Remove the adjuster pin from the shift linkage and discard it.

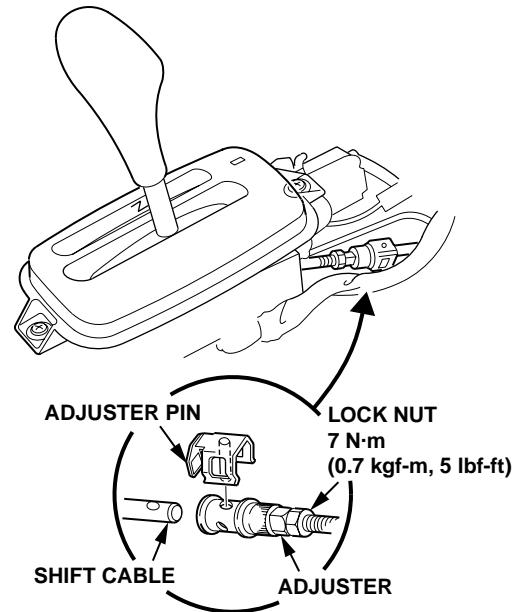

4. Install the new adjuster pin.
 - If the pin feels like it is binding, continue to step 5 to check the shift linkage adjustment.
 - If the pin fits without binding, go to step 6.
5. Remove the adjuster pin. If the holes in the shift cable and adjuster are not perfectly aligned, loosen the locknut and turn the adjuster to align the holes.

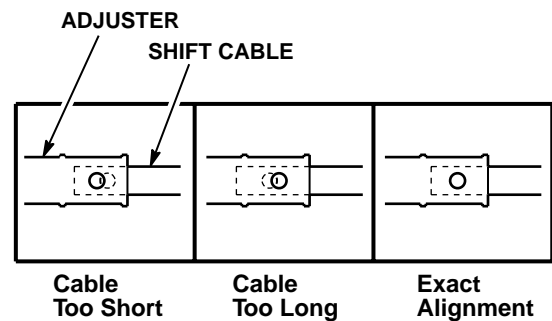

6. Start the engine. Move the shift lever through all the positions, and verify that it selects the proper gears.
7. Reinstall the console.

8. Center-punch a completion mark above the eleventh character of the engine compartment VIN.

Make a center-punch mark above eleventh character.

