



Squeak From the Moonroof Seal

SYMPTOM

The moonroof squeaks when the sunshade is open, the moonroof glass is closed, and the vehicle is moving.

CORRECTIVE ACTION

Install Honda Squeak Reduction tape around the moonroof opening.

REQUIRED MATERIALS

Honda Squeak Reduction Tape
(One roll repairs about 12 vehicles):
P/N 70200-ALL-999

WARRANTY CLAIM INFORMATION

Flat Rate Time: 0.4 hour
Failed Part: P/N 70200-S84-A01
Defect Code: 042

REPAIR PROCEDURE

1. Wipe down the moonroof opening with isopropyl alcohol with a clean towel. This surface must be free of any dirt and grease, or the tape will not stick.
2. Lay a clean shop towel along each moonroof track to prevent grease from getting on your hands or the tape.

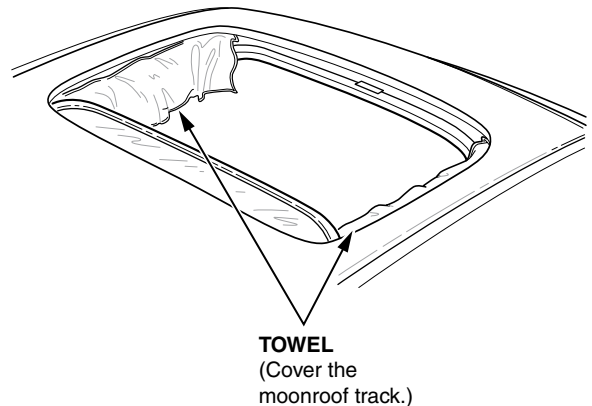

3. Wash your hands thoroughly before applying the tape.
4. Measure and cut off a piece of tape 270 cm (106 inches).
5. Peel the backing off of about 5 cm (2 inches). Hold the tape at the very end of the exposed section.

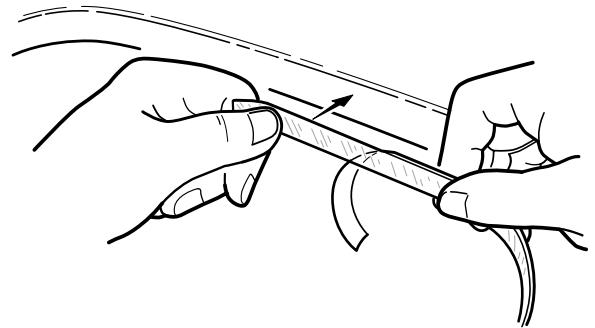

6. Apply 2.5 cm (1 inch) of the tape at the top edge of the moonroof opening. Start at the middle of either the right or left side of the moonroof opening. Do not apply the end piece you touched, or apply the tape above the edges of the opening.

NOTE: Leave enough space to cut off the end section of tape that you touched with your finger.

7. Remove the end piece that you touched with your finger.

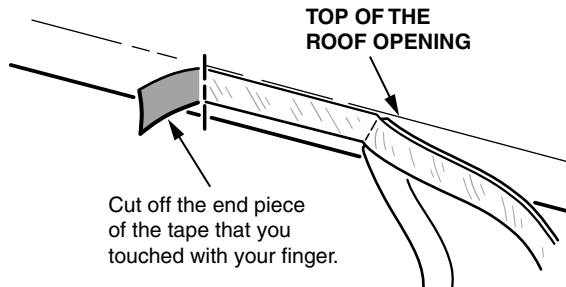

8. Hold the tape up to the roof opening, and peel the backing away from the tape as you move along the opening. Apply about 7.5 cm (3 inches) at a time. Do not apply the tape above the edge of the opening.
9. Carefully slide the thumb of your free hand along the tape, removing any air bubbles.

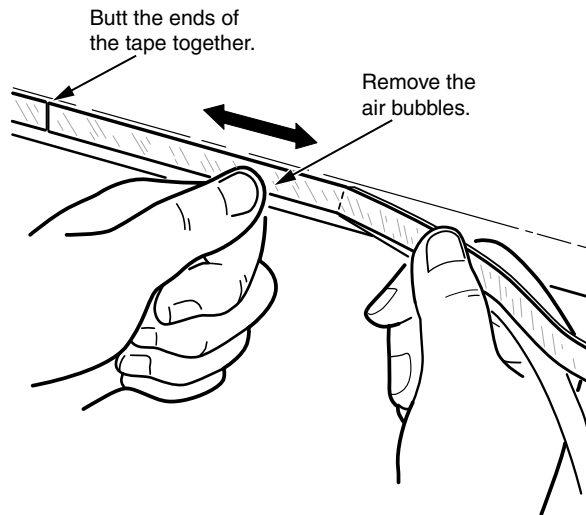

10. Repeat steps 8 and 9 until you have applied the tape around the entire opening and until the ends of the tape butt together. Do not overlap the ends of the tape. Cut off any excess tape.
11. Open and close the moonroof several times to see that it operates smoothly.

NOTE: Do not apply grease to the moonroof seal. The seal will only make noise when moved excessively. When the vehicle is driven, the glass will not move enough to cause noise.