

Applies To: **See VEHICLES AFFECTED****July 2003**

Product Update: 1998–99 Accord 8-Way Power Driver's Seat

BACKGROUND

On affected vehicles, the height adjustment linkage of the 8-way power driver's seat can cause excessive looseness in the seat-back and the seat cushion.

VEHICLES AFFECTED

1998 Accord EX:

KX: From VIN 1HGC22...WA900241
thru 1HGC22...WA900300

1999 Accord EX:

KX: From VIN 1HGC22...XA900001
thru 1HGC22...XA900550

Verify the eligibility of each vehicle by making sure it is shown on your campaign responsibility report.

If any affected vehicles are in your used vehicle inventory, repair them as described in this service bulletin.

CUSTOMER NOTIFICATION

All owners of affected vehicles should be sent a notification of this product update. An example of the customer notification is enclosed with this service bulletin.

CORRECTIVE ACTION

Depending on the condition of the seat linkage, install a seat link support kit, or replace the seat linkage assembly.

PARTS INFORMATION

Seat Link Support Kit (contains two-piece bracket, shoulder nut, and two Allen-head bolts):
P/N 81512-S84-999

WARRANTY CLAIM INFORMATION

OP#	Description	FRT
851139	Install seat link support kit	0.6
851140	Install seat linkage assembly	1.2

Failed Part: P/N 81512-S84-A21

Defect Code: 5BD

Contention Code: L94

REPAIR PROCEDURE

1. Position the driver's seat for removal:
 - Adjust the seat to the middle of its tracks.
 - Adjust the seat cushion height all the way up at the front and rear.
2. Make sure you have the anti-theft code for the radio, then write down the radio station presets.
3. Disconnect the negative cable from the battery.
4. Remove the driver's seat (refer to the 1998–02 Accord Shop Manual).
5. Carefully pry off the two switch knobs from the seat, then remove the recline cover (three screws) and the height outer cover (three screws).

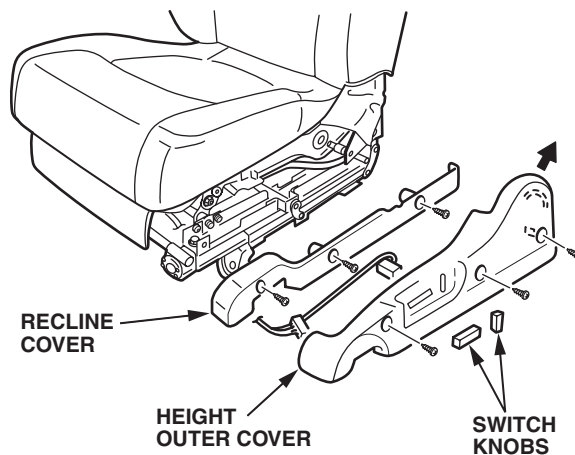

- Remove and discard the 10 mm flange nut that attaches the front torsion tube to the recline adjuster.

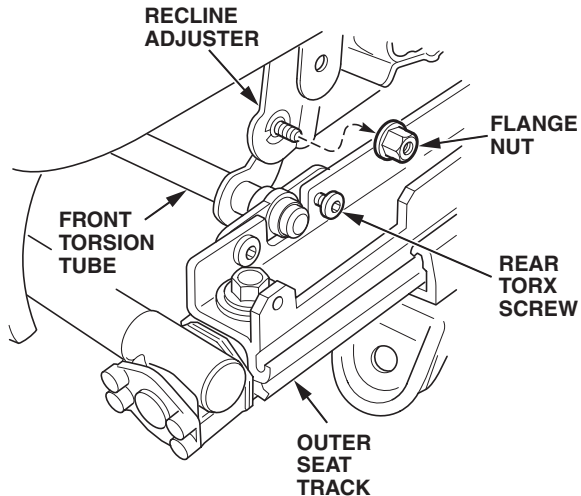

- Loosen the rear Torx screw that attaches the front torsion tube bracket to the outer seat track.
- Look for cracks or other damage on the link welded to the front torsion tube.
 - If the link is OK, go to step 9.
 - If the link is cracked or damaged, replace the seat linkage assembly (refer to the Shop Manual). After you replace the seat linkage assembly, go to step 12.

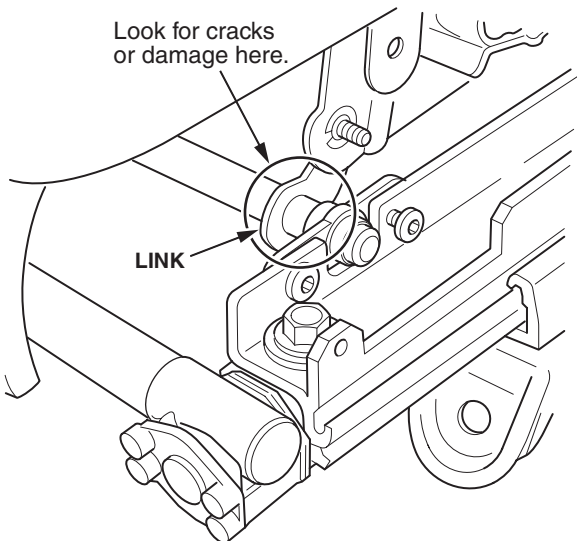

- Place the top half of the seat link bracket on the end of the front torsion tube, then attach the bracket to the recline adjuster with the shoulder nut. Center the inner flange of the shoulder nut in the bracket opening, and hand-tighten the nut.

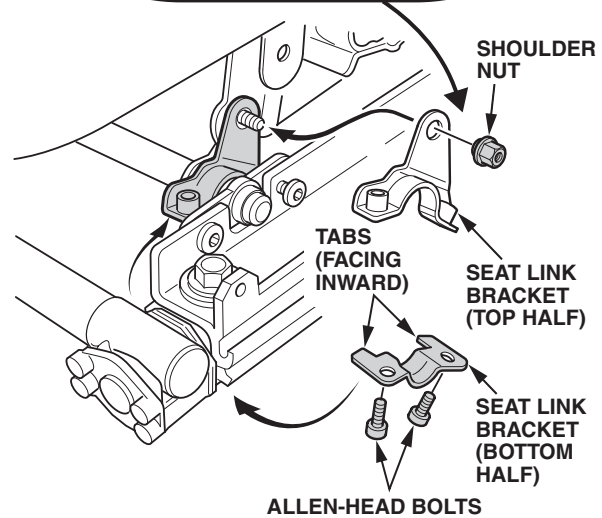
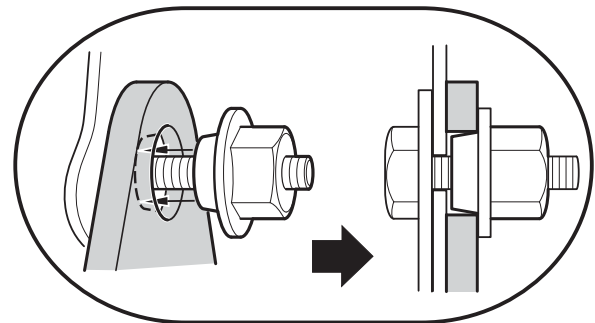

- Position the bottom half of the seat link bracket to the top with the tabs on the bottom half of the bracket facing inward. Hand-tighten the 3/16th-inch Allen-head bolts.
- Torque the screw, nut, and bolts to these specifications:
 - Rear Torx screw: 10 N·m (2.2 lb-ft)
 - Shoulder nut: 8.5 N·m (1.9 lb-ft)
 - Allen-head bolts: 8.5 N·m (1.9 lb-ft)
- Install the recline cover and the height outer cover. Attach the two switch knobs.
- Install the seat (refer to the Shop Manual).
- Reconnect the negative cable to the battery.
- Enter the anti-theft code for the radio.
- Enter the radio station presets, and set the clock.
- Center-punch a completion mark above the 6th character of the engine compartment VIN.

Center-punch here.

1HGXXXXXXXXXXXXXX