



Throttle Body Cleaning

SYMPTOM

When the engine is first started after the vehicle has been parked overnight, customers may “feel” the release of the throttle plate through the accelerator pedal. Some describe it as a one-time “pop” sensation.

Customers may have trouble explaining this condition because

- They cannot repeat it, since it happens only one time, when the engine is cold.
- The accelerator pedal works normally at all other times.
- There are no other symptoms.
- It may be intermittent, happening only during cooler weather.

PROBABLE CAUSE

The symptom is caused by normal buildup of contaminants in the throttle bore, combined with expansion and contraction of the throttle body.

CORRECTIVE ACTION

Partially remove the throttle body, and clean it with Honda carburetor cleaner or throttle plate and induction cleaner.

WARRANTY CLAIM INFORMATION

In warranty: The normal warranty applies.

Flat Rate Time: 0.6 hour

Failed Part: P/N 16400-PAA-A61

Defect Code: 030

PARTS INFORMATION

Throttle Body Gasket (used only if needed):

P/N 16176-PAA-A01

REQUIRED MATERIALS

Carburetor Cleaner: P/N 08732-0006

or

Throttle Plate and Induction Cleaner: P/N 08732-9009

REPAIR PROCEDURE

1. Remove the breather pipe from the air intake duct, unclip the vacuum line from the duct, and remove the duct from the throttle body.

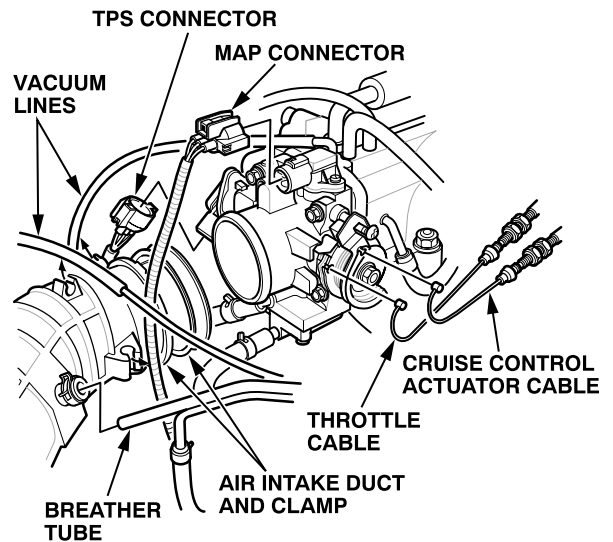

2. Disconnect the throttle position sensor (TPS) and manifold absolute pressure (MAP) connectors from the throttle body.
3. Remove the throttle cable and, if equipped, the cruise control actuator cable from the throttle body.

- Remove the throttle body mounting nuts and bolts, then slide the throttle body off of the studs on the intake manifold chamber. Leave the coolant hoses connected.

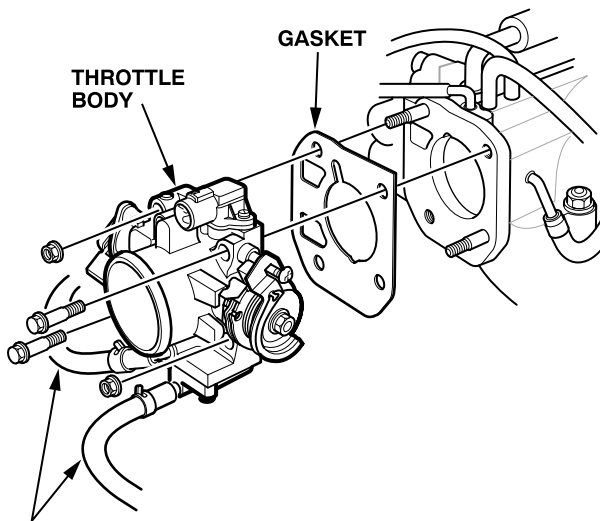

Leave the coolant hoses connected.

- Put a shop towel under the throttle body, open the throttle, then clean out any contaminants from the intake manifold side of the throttle body with carburetor cleaner or throttle plate and induction cleaner.

NOTE: To avoid damaging the idle air control valve (IACV), spray the cleaner through the back of the throttle body, not the front.

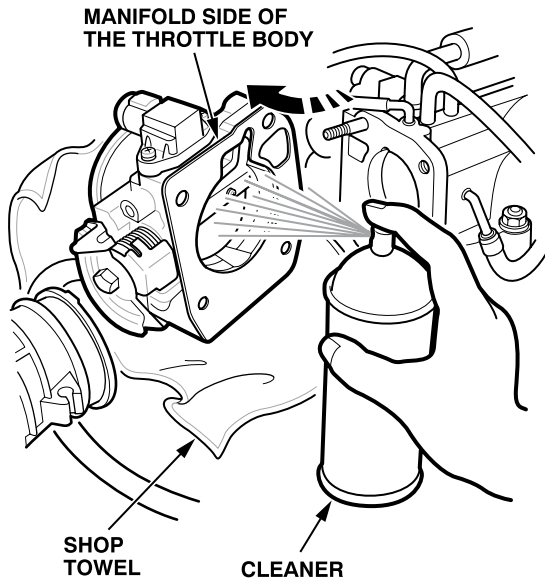

- Check the throttle body gasket for damage, and replace it with a new one if needed.

- Reinstall all parts in reverse order of removal. Torque the throttle body nuts and bolts to 22 N·m (16 lb-ft).
- Adjust the cruise control actuator cable. (Refer to the 1998 Accord L4 Shop Manual.)
- Adjust the throttle cable. (Refer to the Shop Manual.)
- Make sure the accelerator pedal works normally, and all hoses and cables are routed correctly.