



Steering Column Removal and Installation

SRS components are located in this area. Review the SRS component locations (see page 23-10) and precautions and procedures (see page 23-11) in the SRS section before performing repairs or service.

Removal

1. Record the radio station presets, and disconnect the battery.
2. Remove the driver's airbag assembly and the steering wheel (see page 17-22).
3. Remove the driver's dashboard lower covers (see page 20-61).
4. Remove the column covers (A).

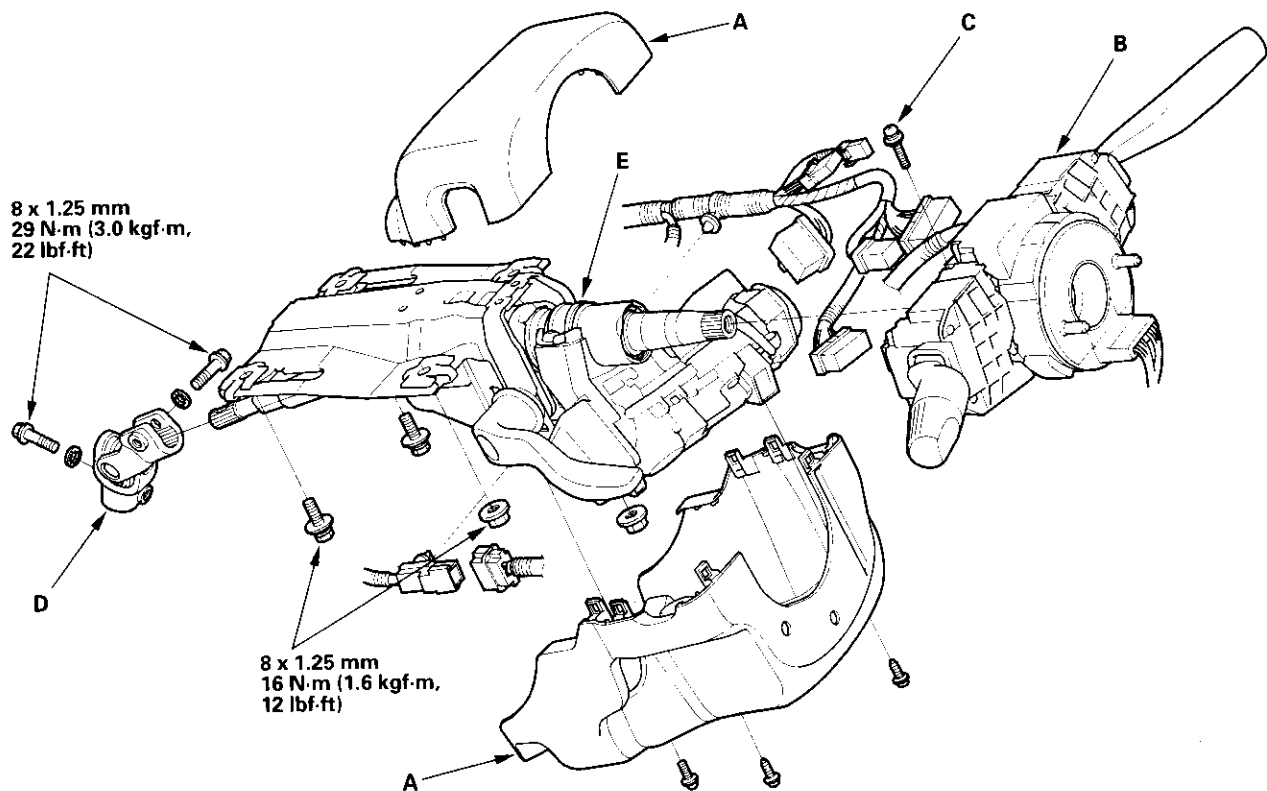

5. Remove the combination switch assembly (B) from the steering column shaft by removing the screw (C) on the top of the combination switch. Disconnect the 5P, 14P, and 16P connectors from the switch.
6. Disconnect the 6P and two 7P connectors from the ignition switch. Disconnect the harness clips from the steering column.
7. Disconnect the steering joint (D), and remove it from the column shaft.
8. Remove the steering column (E) by removing the attaching nuts and bolts.

(cont'd)

Power Steering

Steering Column Removal and Installation (cont'd)

Installation

1. Install the steering column in the reverse order of removal, and note these items:
 - Take care not to let the sliding capsules fall out of the position during column installation.
 - Make sure the wires are not caught or pinched by any parts.
2. Insert the upper end of the steering joint onto the steering shaft (A) (line up the bolt hole (B) with the flat portion (C) on the shaft).

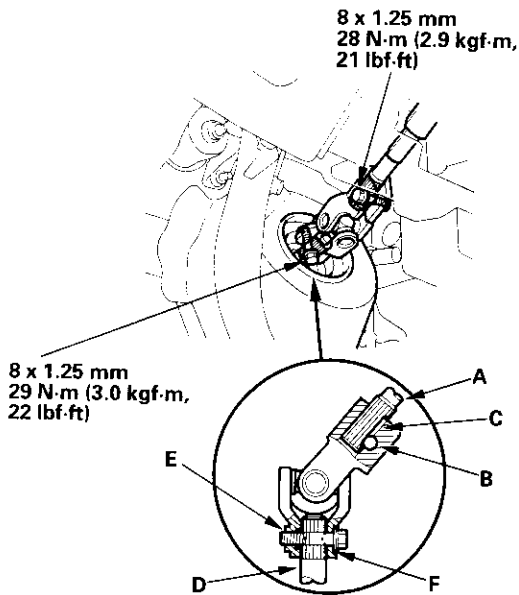

3. Slip the lower end of the steering joint onto the pinion shaft (D) (line up the bolt hole (E) with the groove (F) around the shaft), and loosely install the lower joint bolt. Be sure that the lower joint bolt is securely in the groove in the pinion shaft.
4. Pull on the steering joint to make sure that the steering joint is fully seated. Then install the upper joint bolt and tighten both bolts to the specified torque.

5. Finish the installation and note these items:

- Make sure the wire harness is routed and fastened properly.
- Make sure the connectors are properly connected.
- Reinstall the steering wheel (see page 17-24).
- Reconnect the battery.
- Do the PCM idle learn procedure (see page 11-149).
- Do the power window control unit reset procedure (see page 22-139).
- Enter the anti-theft code for the radio, then enter the customer's radio station presets.
- Set the clock.
- Verify horn and turn signal switch operation.
- Check wheel alignment, if necessary (see page 18-4).