



Shift Cable

Adjustment

CAUTION:

- All SRS electrical wiring harnesses are covered with yellow outer insulation.
- Before disconnecting the SRS wire harness, install the short connector on the airbag (see page 23-273).
- Replace the entire affected SRS harness assembly if it has an open circuit or damaged wiring.

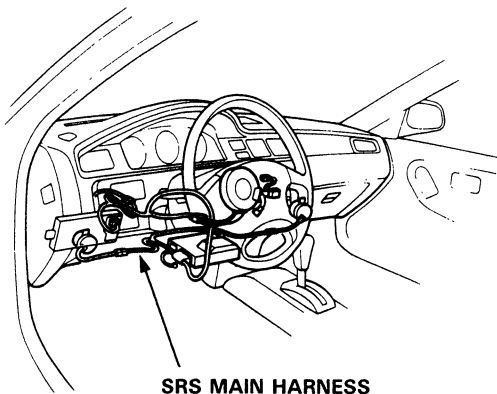

▲ WARNING Make sure lifts are placed properly (see page 1-10 thru 1-12).

1. Start the engine. Shift to **P** position to see if the reverse gear engages. If so, refer to troubleshooting on page 14-42 thru 45.
2. With the engine off, remove the center console (see page 20-72).
3. Shift to **N** position, then remove the lock pin from the cable adjuster.

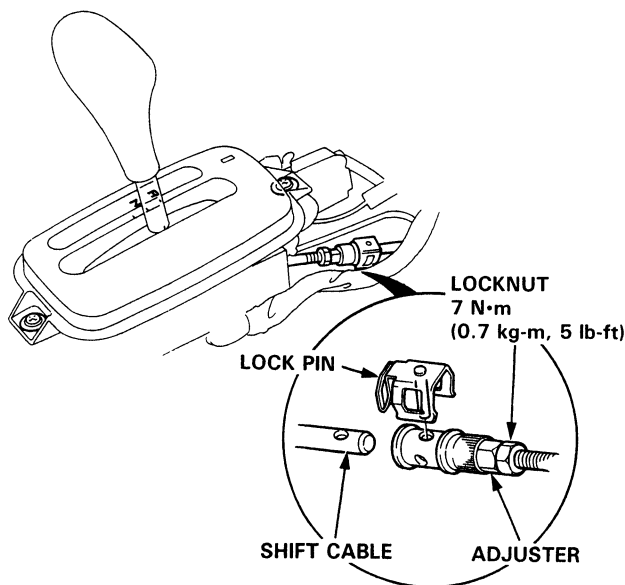

4. Check that the hole in the adjuster is perfectly aligned with the hole in the shift cable. There are two holes in the end of the shift cable. They are positioned 90° apart to allow cable adjustment in 1/4 turn increments.

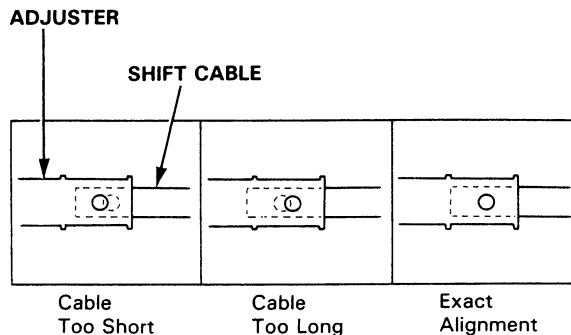

5. If not perfectly aligned, loosen the locknut on shift cable and adjust as required.
6. Tighten the locknut to 7 N·m (0.7 kg-m, 5 lb-ft).
7. Install the lock pin on the adjuster. If you feel the lock pin binding as you reinstall it, the cable is still out of adjustment and must be readjusted.
8. Move the select to each gear and verify that the shift position indicator follows the shift position console switch.
9. Start the engine and check the shift lever in all gears. If any gear does not work properly, refer to troubleshooting on page 14-42 thru 45.
10. Insert the ignition key into the key cylinder on the shift indicator panel, verify that the shift lock lever is released.

Gearshift Selector

Disassembly/Reassembly

CAUTION:

- All SRS electrical wiring harnesses are covered with yellow outer insulation.
- Before disconnecting the SRS wire harness, install the short connector on the airbag (see page 23-273).
- Replace the entire affected SRS harness assembly if it has an open circuit or damaged wiring.

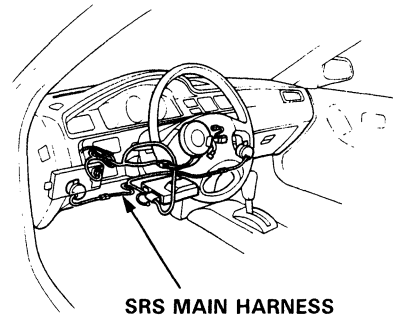

SRS MAIN HARNESS

