

# Clutch Pedal

## Adjustment

NOTE: The clutch is self-adjusting to compensate for wear.

**CAUTION:** If there is no clearance between the master cylinder piston and push rod, the release bearing is held against the diaphragm spring, which can result in clutch slippage or other clutch problems.

1. Loosen locknut A, and back off the adjusting bolt until it no longer touches the clutch pedal.
2. Loosen locknut B, and turn the push rod in or out to get the specified stroke and height at the clutch pedal.
3. Tighten locknut B.
4. Thread the adjusting bolt in until it contacts the clutch pedal.
5. Turn the adjusting bolt in 1/4–1/2 turn further.
6. Tighten locknut A.

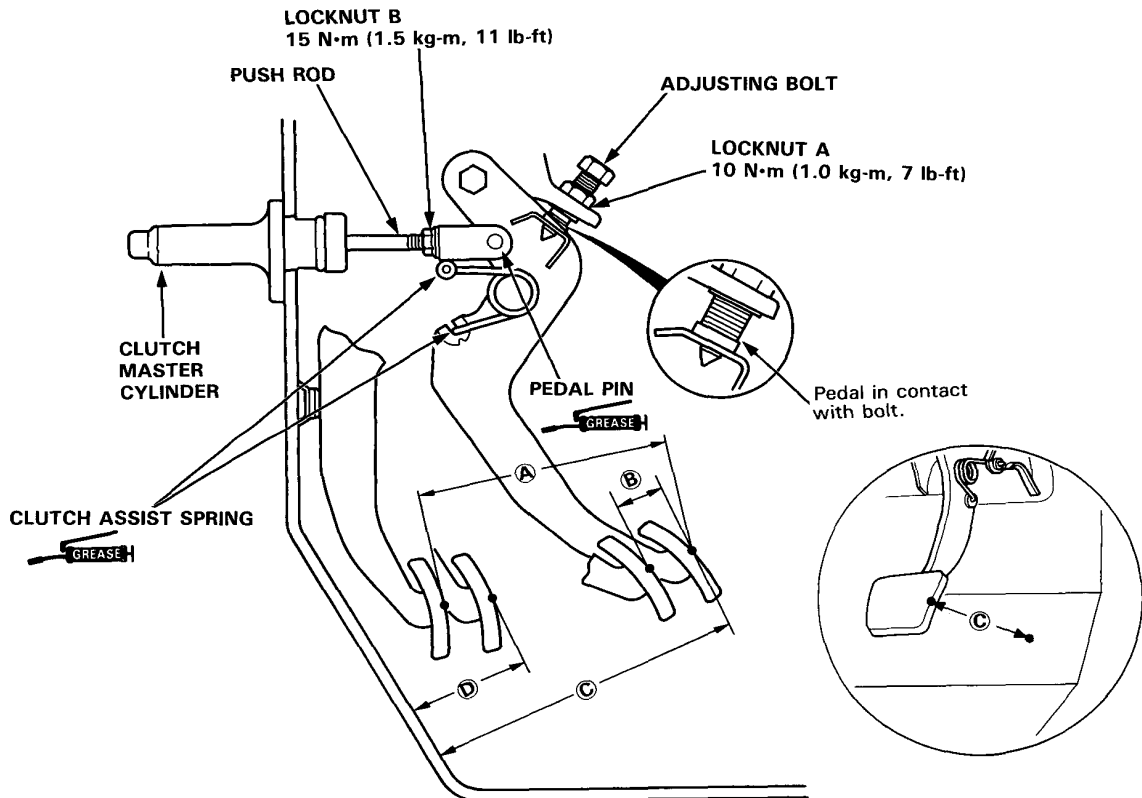

- Ⓐ STROKE at PEDAL: 142 mm (5.59 in)
- Ⓑ TOTAL CLUTCH PEDAL FREE PLAY: 9.0–15.0 mm (0.35–0.59 in) including the pedal play 1–7 mm (0.04–0.28 in).
- Ⓒ CLUTCH PEDAL HEIGHT: 210 mm (8.27 in) to the floor.
- Ⓓ CLUTCH PEDAL DISENGAGEMENT HEIGHT: 90 mm (3.54 in) minimum to the floor.